

4

3

2

1

B

B

A

A

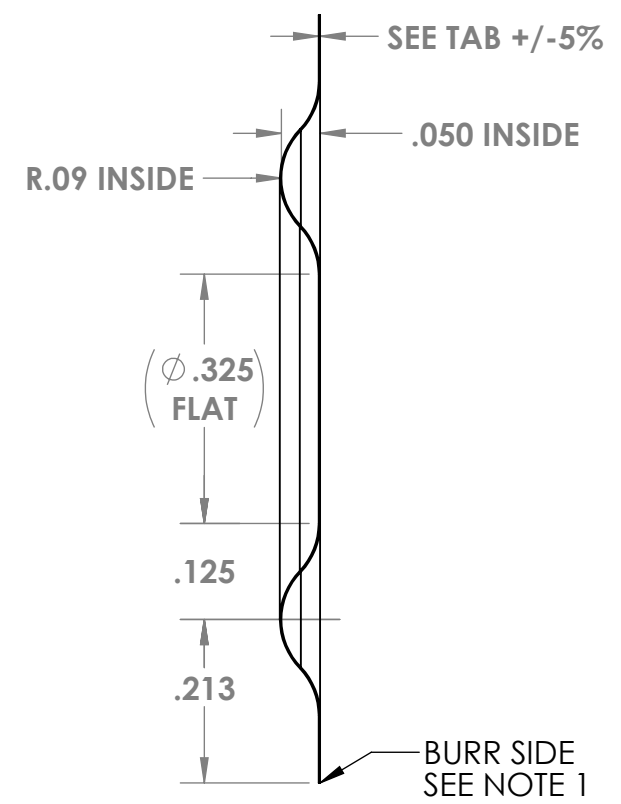
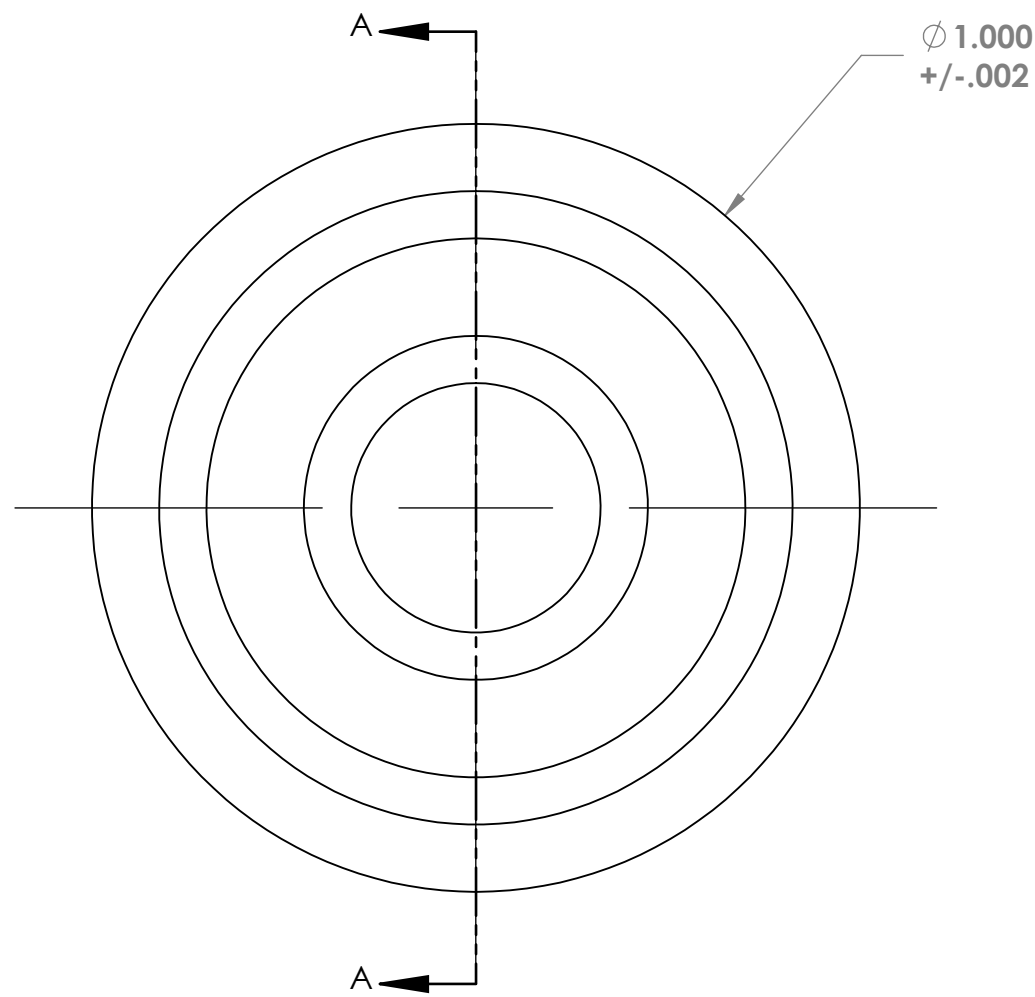

SECTION A-A

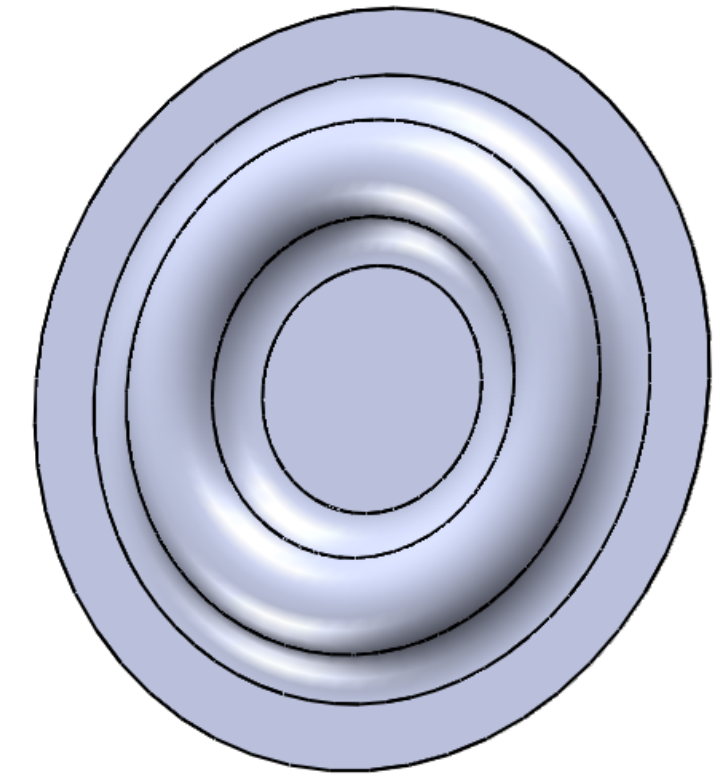

GENERAL NOTES:

- 1) BURR TO BE 30% OF MATERIAL THICKNESS
- 2) MAX CAMBER (POTATO CHIPPING) OF 2% OF OD
- 3) ALL RIPPLE DIMENSIONS IN VIEW B ARE TOOL CONTROLLED
- 4) MANUFACTURE DIAPHRAGM FROM TOOL T-LSHP-1.000
- 5) DINGS AND DENTS ACCEPTABLE IF DETECTED ON ONE SIDE ONLY
- 6) DIAPHRAGMS TO BE NESTED AND PACKED TO AVOID DAMAGE

TAB	Part Name	Diameter	Thickness	Material	Specification	Deflection *
-1	LSHP1.000-0020-718	1.000	0.002	IC718	AMS-5596	0.001
-2	LSHP1.000-0030-316	1.000	0.003	SS316L	AMS-5507	0.001
-3	LSHP1.000-0030-625	1.000	0.003	IC625	AMS-5599	0.002
-4	LSHP1.000-0030-718	1.000	0.003	IC718	AMS-5596	0.002

* Deflections Listed are at 1 psi and for reference only. Full range of deflections are available.

UNLESS OTHERWISE SPECIFIED:
 DIMENSIONS ARE IN INCHES
 TOLERANCES:
 FRACTIONAL $\pm 1/32$
 ANGULAR: MACH \pm BEND \pm
 TWO PLACE DECIMAL $\pm .015$
 THREE PLACE DECIMAL $\pm .005$
 INTERPRET GEOMETRIC
 TOLERANCING PER: ASME Y14.5M94
 DO NOT SCALE DRAWING

	NAME	DATE	TITLE: Metal Diaphragm	
DRAWN	WAGNER	9-22-15		
CHECKED	DEBONE	9-22-15		
ENG APPR.				
MFG APPR.				
Q.A.			PROPRIETARY AND CONFIDENTIAL THE INFORMATION CONTAINED IN THIS DRAWING IS THE SOLE PROPERTY OF HUDSON TECHNOLOGIES. ANY REPRODUCTION IN PART OR AS A WHOLE WITHOUT THE WRITTEN PERMISSION OF HUDSON TECHNOLOGIES IS PROHIBITED.	
SIZE	DWG. NO.	REV		
B	LSHP1.000-TAB	B		
SCALE: 4:1	WEIGHT:	SHEET 1 OF 1		

4

3

2

1