

4

3

2

1

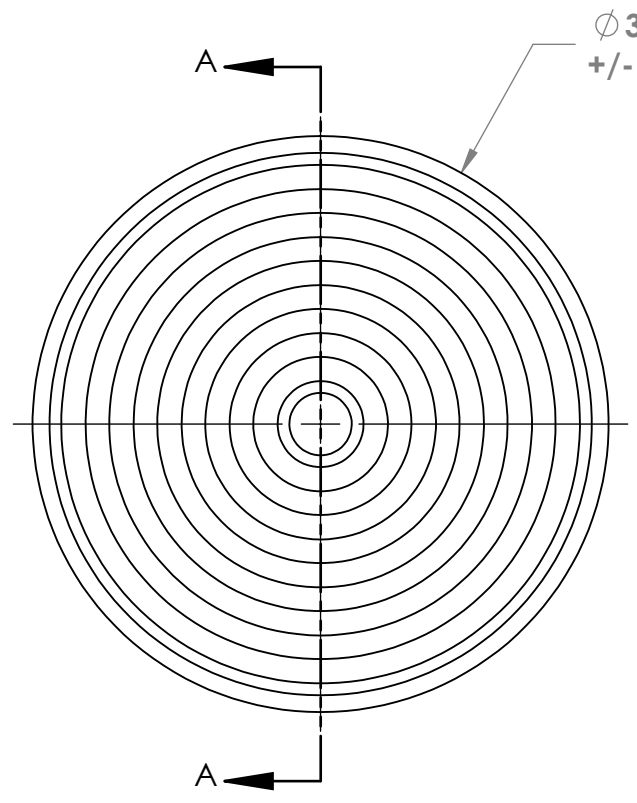

ϕ 3.000
+/- .002

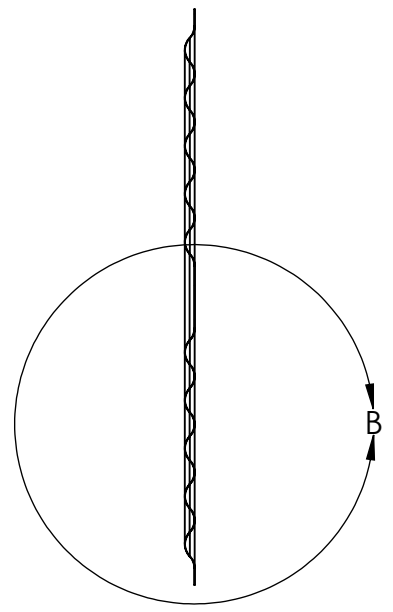

SECTION A-A

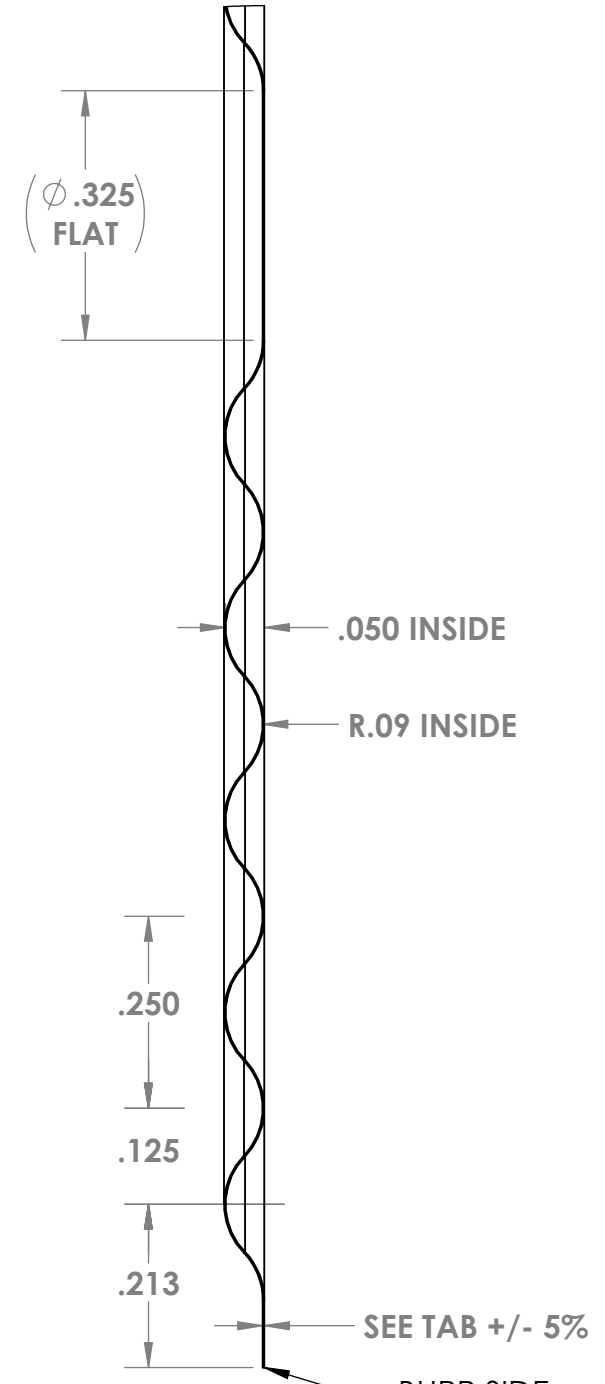

DETAIL B
SCALE 4 : 1

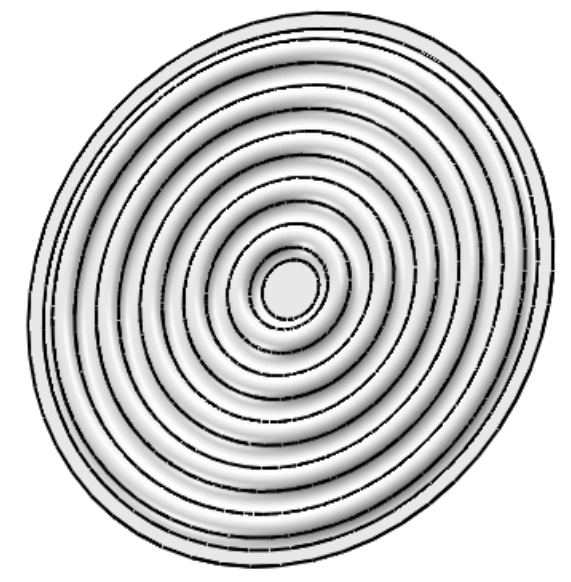

GENERAL NOTES:

- 1) BURR TO BE 30% OF MATERIAL THICKNESS
- 2) MAX CAMBER (POTATO CHIPPING) OF 2% OF OD
- 3) ALL RIPPLE DIMENSIONS IN VIEW B ARE TOOL CONTROLLED
- 4) MANUFACTURE DIAPHRAGM FROM TOOL T-LSHP-3.000
- 5) DINGS AND DENTS ACCEPTABLE IF DETECTED ON ONE SIDE ONLY
- 6) DIAPHRAGMS TO BE NESTED AND PACKED TO AVOID DAMAGE

TAB	Part Name	Diameter	Thickness	Material	Specification	Deflection *
-1	LSHP3.000-0020-718	3.000	0.002	IC718	AMS-5596	0.033
-2	LSHP3.000-0030-316	3.000	0.003	SS316L	AMS-5507	0.014
-3	LSHP3.000-0030-625	3.000	0.003	IC625	AMS-5599	0.017
-4	LSHP3.000-0030-718	3.000	0.003	IC718	AMS-5596	0.017

* Deflections Listed are at 1 psi and for reference only. Full range of deflections are available.

UNLESS OTHERWISE SPECIFIED:
DIMENSIONS ARE IN INCHES
TOLERANCES:
FRACTIONAL \pm 1/32
ANGULAR: MACH \pm BEND \pm
TWO PLACE DECIMAL \pm .015
THREE PLACE DECIMAL \pm .005
INTERPRET GEOMETRIC
TOLERANCING PER: ASME Y14.5M94
DO NOT SCALE DRAWING

	NAME	DATE	TITLE: Metal Diaphragm	
DRAWN	WAGNER	9-22-15		
CHECKED	DEBONE	9-22-15		
ENG APPR.				
MFG APPR.				
Q.A.			PROPRIETARY AND CONFIDENTIAL THE INFORMATION CONTAINED IN THIS DRAWING IS THE SOLE PROPERTY OF HUDSON TECHNOLOGIES. ANY REPRODUCTION IN PART OR AS A WHOLE WITHOUT THE WRITTEN PERMISSION OF HUDSON TECHNOLOGIES IS PROHIBITED.	
SIZE	DWG. NO.	REV		
B	LSHP3.000-TAB	B		
SCALE: 1:1	WEIGHT:	SHEET 1 OF 1		

4

3

2

1